



OWNER'S MANUAL

UGR-2350-H
UFF-2350-MD

This manual is provided in conjunction with instructions and spare part lists to fully inform the relevant personnel in usage and maintenance.

Contents

Document store with vehicle manual.....	1
Description.....	2
Features & Specification	2
Compliance label.....	3
Safety Labels.....	4
Precautions.....	5
Safety Direction of Use	5
Components - Maintenance.....	6
Diagram	7
Parts List	8
Parts Drawings	9-12
Assembly installation	13- 14
Guard's fitting.....	15
Ratchet uses	16- 17
Load safely of ratchet.....	18
How not to load.....	19
Poles attaching.....	20
Warranty.....	21

Description

UGR-2350-H
Ute Glass Rack
High series

UFF-2350-MD
Ute Fixed Frame
Medium series

Are a conveyance, compact, time saving of transporting glass, to job site, shops front repair and domestic application

Ute drop side is for easy of two men handling glass at safety handling height.

The inner lower height "A" tray side, for small glass or long narrow glass sizes

Feature & Specification:

Vehicle attach glass rack, in galvanize plus powder coated white with rubberize of EPDM.

2350 mm length fitting common 2.4mm ute trays, within head board and tray rear.

Four ratchet poles 1945 mm H. drop-side 'A'

Four ratchet poles 1450 mm H. inner 'A' side

The rubberize poles are peg position space at bottom base, with ratchet straps adjustable of pull in at top securing any glass.

Ledger (drop side slot track) to accommodate toggles poles if desired

Aacken
created with ingenuity built on integrity.

**UTE FIXED
A- FRAME
UFF - 2350 - MD**

**Tare 128 kgs
Low 'A' 600 kgs
High 'A' 860 kgs
W.L.L 1600 kgs
B/Nr UFFM - #####
S/Nr UFF22 - ###
Year 20##**

Aacken
created with ingenuity built on integrity.

**UTE FIXED
A- FRAME
UGR - 2350 - H**

**Tare 157 kgs
Low 'A' 940 kgs
High 'A' 860 kgs
W.L.L 1970 kgs
B/Nr UGRH - #####
S/Nr UGR22 - ###
Year 20##**



WARNING

- READ COMPLIANCE PLATE AND ALL LABELS ALSO MANUAL + P.H.A. BEFORE USING.
- UNBALANCED LOAD TO BE LIFTED FROM BASE ONLY !!
- DO NOT PASS UNDER A - FRAME WHEN REMOVING OR FITTING SLINGS, WHEELS OR TROLLEYS.

LOAD - CAUTION

- LOAD + FRAME TARE NOT TO EXCEED W.L.L.
- LOAD TO BE SECURED BY LOAD BAR, STRAPS, ROPES ETC.
- LOAD NOT TO EXCEED LOAD BAY HEIGHT
- LOAD NOT TO EXCEED LOAD BAY LENGTH

MAINTENANCE

- ALL LABELS + COMPLIANCE PLATE ARE TO BE CLEAN.
- A - FRAME, BOLTS, LOAD BARS, STRAPS ETC. MUST BE INSPECTED BEFORE USE, FOR LOOSE, DAMAGE OR WORN
- FRAME AND RUBBER TO BE CLEAN EVERY MONTH.

DANGER

- ☐ DAMAGE FRAME, LOAD BAR, STRAPS ARE NOT TO BE USED.
- ☐ ACCIDENT WILL OCCUR IF LOAD IS NOT SECURED BEFORE MOVING.
- ☐ AVOID ACCIDENT BY ENSURING ALL GLASS IS SECURE

LEAN - CAUTION

- MODERATE VEHICLE INCLINE OR DECLINE IS PERMISSIBLE FOR UNLOADING.
- 'A'S OF BOTH SIDE MUST NOT BE LESS THEN 93' OF VEHICLE RACK- AFRAME UNLOADING

SAFETY - CAUTION

- SAFETY CLOTHING TO BE WORN.
- A - FRAME TO BE LEVEL FOR LOADING OR UNLOADING.
- DO NOT USED IN WET OR WINDY CONDITIONS.
- ONLY TRAINED AND COMPETENT PERSONAL TO USE.

INSPECTION



(YEARLY)

FRAME	<input type="checkbox"/>	LOAD BARS	<input type="checkbox"/>	PINS	<input type="checkbox"/>
WELDS	<input type="checkbox"/>	STRAPS	<input type="checkbox"/>	RUBBER	<input type="checkbox"/>
BOLTS	<input type="checkbox"/>	SHACKLES	<input type="checkbox"/>	CAPS	<input type="checkbox"/>
EYELETS	<input type="checkbox"/>	WHEELS	<input type="checkbox"/>	LABELS	<input type="checkbox"/>

SIGN :

DATE :

LIABILITY

- NO LIABILITY WILL BE CLAIMED AGAINST AACKEN, AACKEN INDUSTRIES OR AACKEN INDUSTRIES INT. LTD. OR IT'S DISTRIBUTORS FOR ACCIDENT(S).
- USER AND BUYER MUST READ, UNDERSTAND AND COMPLY WITH ALL LABELS + COMPLIANCE PLATE.

Precaution:

- Inspection to carrier out before each use
- Check all bolts are tight of rack base to UTE tray, and end's ledger guard.
- Wheel guard or stone / mud guard are attach.
- Load tie bars must be with frame or load toggle brace security poles (4 long, 4 short)
- Check rubber and straps, ratchet, etc. for damage
- Read and understand compliance and all labels

Safety Use:

- Vehicle-rack to be on level surface for loading and unloading
- Do not load or unload in wet or windy condition
- Do not exceed compliance W.L.L with loads
- Load to be secure before moving vehicle
- Do not unload/load when 'A' is less 93° to gravity
- Use ur mobile fone to get safety degree
- Do not unload on street without barricade
- Loaded vehical lifting heavy glass off rack two Men required or vacuum hoisting equipment
- Night: unloading with ample lighting check degree
- Lean with smart fone 93°
- Ensure unattended glass whilst unloading is temporary secured, as of unexpect traffic wind.

Components

ABA:

- Aacken Bolt assembly -

Vehicle with attach –fix Rack- aframe to be fitted
With galvanize or stainless steel bolts of 8.8 or 9.8
grade. Local bolt supplier with have size's to suit.

Diameter	Wrench	Dry Torque	Wet Torque
M10	16mm	50Nm	45Nm
M12	18mm	85Nm	76Nm

RTAA:

- Rack Table- Tray Aframe Assemble -

URG-2350, series only fitted to vehicle, comply to road-
traffic authority regulation

Rack mounting: { license equipment fitters
license engineer fitters

Procedures:

- Check vehicle compile to all requirement
- Check mounting, sizes ect.
- Check if rack fitted to right vehicle side only, left or
- L and R with 2 unit.
- Be familiar with regulation, overhang, size, W.L.L ect.

Maintenance:

URG / UFF Series are galvanize+ P/coat white or gray,
with rubberize EPDM

- Wash clean rack monthly
- Inspect EPDM rubber base, grommet, load poles
- Load poles ratchet to be WD.40 or white lithium grease
monthly (ensure not to get on straps)
- Straps inspect for cut or damage (stichers ...ect...)
- Straps quarterly, clean, let dry, then damp cloth with
formula1 tire shine, or similar silicone polymer
spray or liquid

Diagram

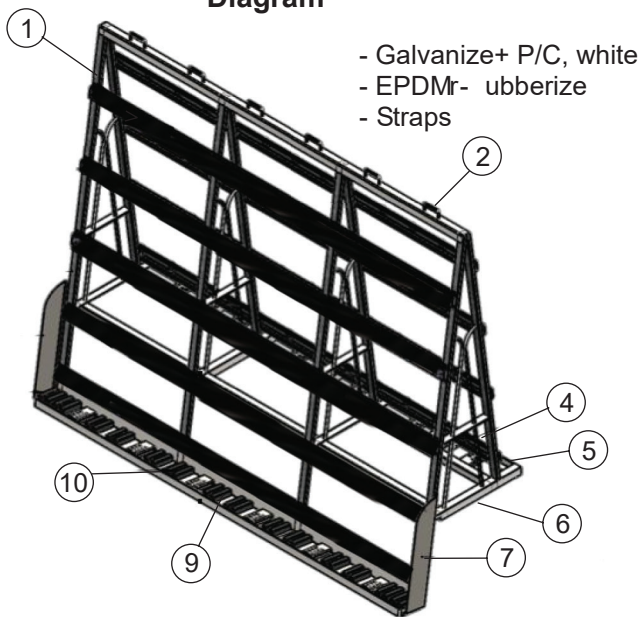

DESCRIPTION Nr's

- ① Ute glass rack (over side vehicle aframe)
- ② Top loop tie rails
- ④ End vertical tie rails
- ⑤ Ledger inner tray side
- ⑥ Base (bolt to be filled to vehicle)
- ⑦ Left and right protection guards
- ⑨ Ledger drop side, with toggle track
- ⑩ Base pole slott

Part List

<u>Pos.Nr</u>	<u>Qty</u>	<u>Code Part</u>	<u>Description</u>
①	1	URG-2350-H or UFF- 2350-MD	Over side rack-aframe
⑦	}	1 SG -L	Ledger left stone guard
⑦A		1 SG -R	Ledger right stone guard
②P		4 RSP-1450	Inner ratchet strap poles
①P		4 RSP-1945	Outer (Page 10)

<u>Page</u>	<u>Qty</u>	<u>Bolts Parts</u>	<u>Description</u>
9	8	M12 Bolt	Galvanize, grade 8.8 or 8.9
Nr ⑥	16	M12 (2 per bolt)	Galvanize, flat washer 2.5 thick
	8	M12 spring washer	Galvanize
	8	M12 Nut	Galvanize
(bolt by fitter as of different vehicle tray design)			

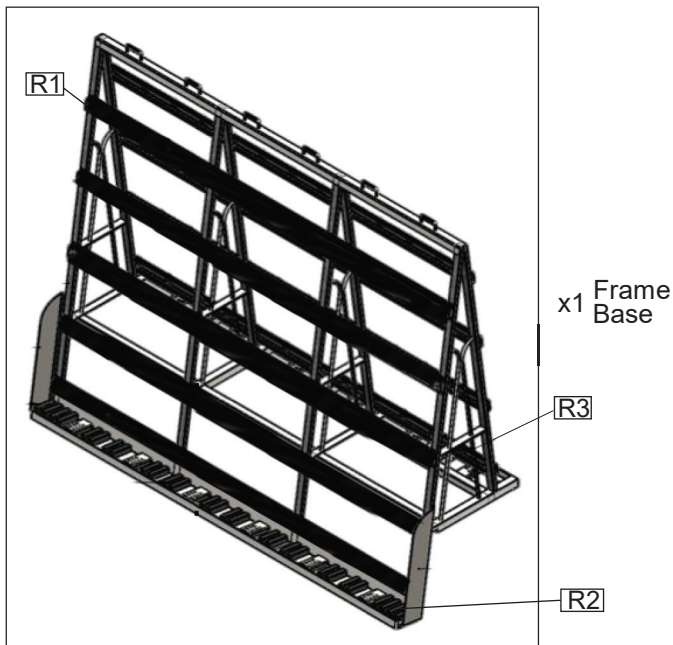

<u>Page</u>	<u>Qty</u>	<u>Rubber Parts</u>	<u>Description</u>
R1	7 / 9	TRSR-42/2345	EPDM Horizontal
R2	14	U-72-B	EPDM (drop side ledger)
R3	10	NR-49B	EPDM , saddle base,(inner)
R4	4	TSR-42/1450 E	PDM , inner poles
R5	4	TSR-42/1450	EPDM ledger side poles

M / H



x4 RSB-1945



x4 RSB-1450



Front ledger stop guard
x1 Front stop



Rear ledger protection guard
x1 Back stop

Part list

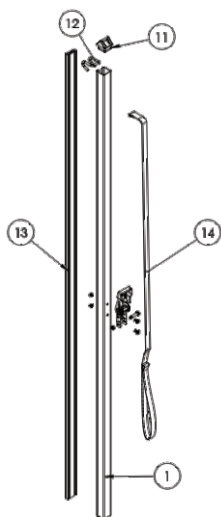

Balloon	Length	Product code
1	950mm	SRP - 950
Options		
2	2000mm	SRP - 2000
3	2090mm	SRP - 2090
4	2500mm	SRP - 2500

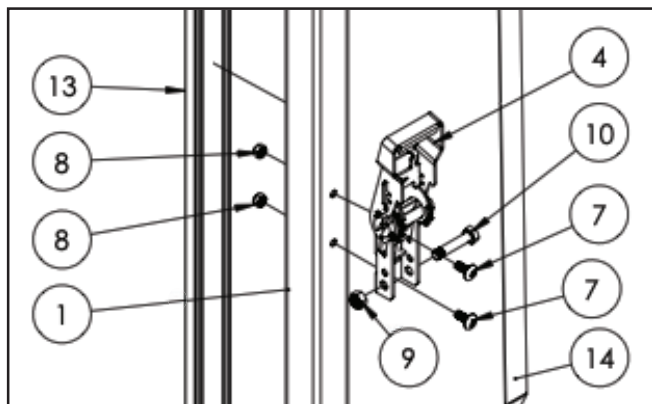

SRP - Assem1			
Balloon	Product code	Description	QTY
P1	RSP-1945	Ratchet safety load pole	4
P2	RSP-1450	Ratchet safety load pole	4
4	R-25/750	Ratchet 25-750	8
6			
7	R-25/13	Ratchet base bolts	16
8	M6-NN	M6- Nylon lock nut	16
9	R-25/SB	Ratchet strap bolt N/N	8
10	R-25/SN	Ratchet strap N/N	8
11	S/SGE-W	20-40 strap guide eyelet	8
12	S/UH-25	Strap U-hook 16R	4
12A	S/hook-25	Swan lock strap hook	4
13	TSR-42/1450	Pole rubber EPDM-G	4
13A	TSR-42/1945	Pole rubber EPDM-G	4
14	S25-1300	Strap white 25/1.3mm	4
14A	S25-1900	Strap white 25/1.9mm	4

Installation

UFF/UGR can be installed on the driver side, on the passage side or both side

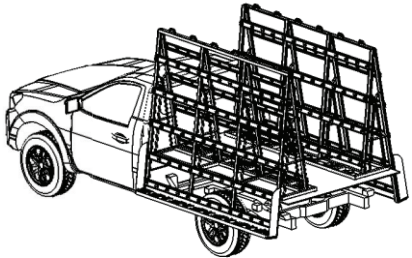
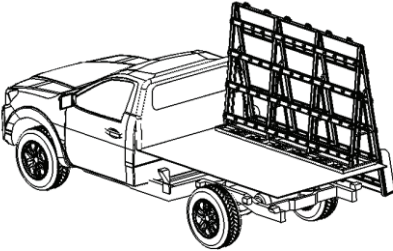

State's law's do
Vary check with
state road authority,
If regulation been
new dated

Installation

UFF/UGR to be installed by the engineer company of license equipment fitter

Note: UFF/UGR must be installed on a flat tray top-bed with backing support plate on under side with securing bolt sets

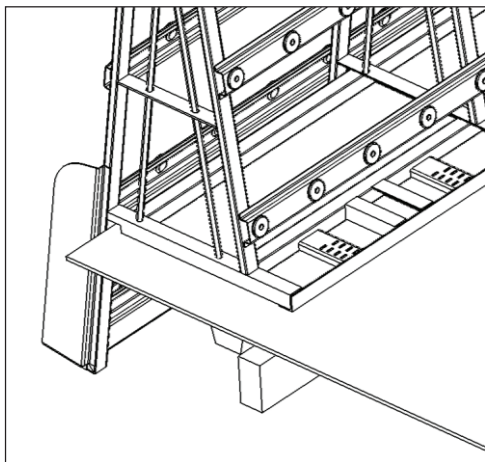

Installation

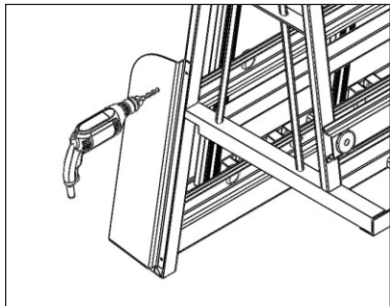

Using the plate stop guard hold with clamp then drill x4 holes into the ute frame

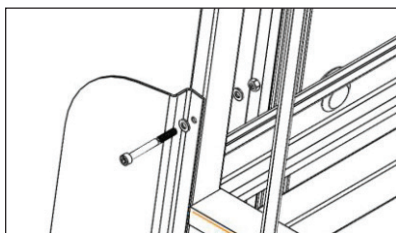

Install x1 hexagon key socket with x2 washer and x1 lock nut all to be stainless steel

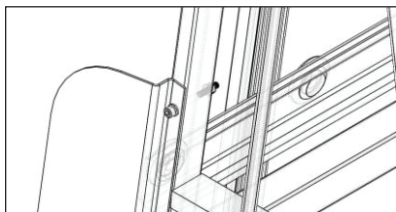

Hard ware not included
 e.g Stainless steel per hole
 x1 Hexagon key socket
 M6 50mm
 x2 Washer M6
 X1 Lock Nut M6

General uses

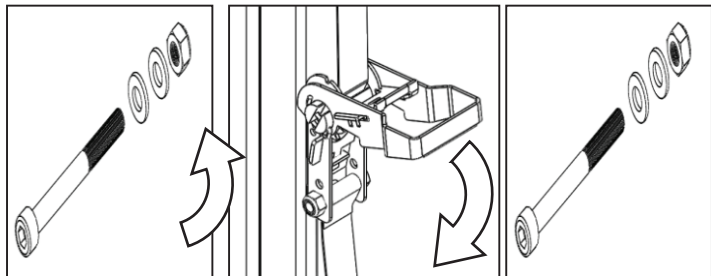

How to ratchet - From lock position lift handle upwards at 90 degrees and back down Repeat this until load is secure. When load secured set handle back to lock position.

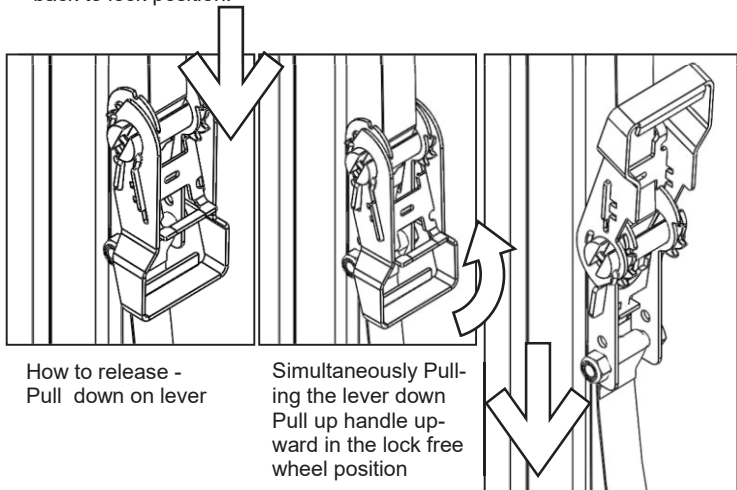

How to release -
Pull down on lever

Simultaneously Pulling the lever down
Pull up handle upward in the lock free wheel position

Important notice

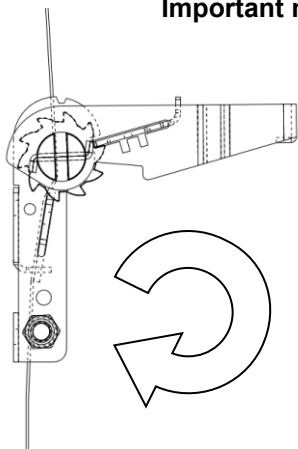

Insure that the ratchet Windlass/slot opening has rotated a minimum of 180 degrees from Windlass/slot opening at vertical position when secure the load

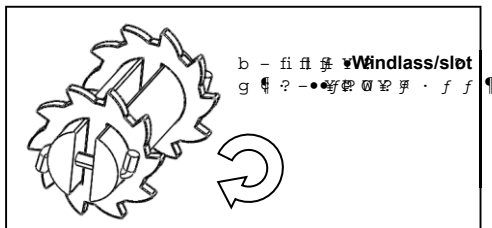
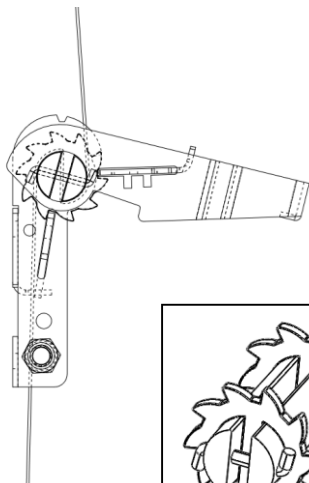

Examples

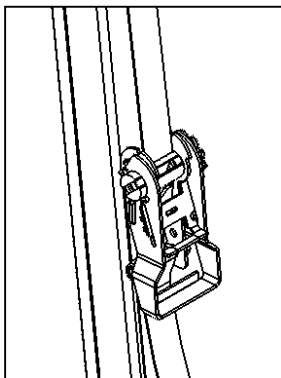

Ratchet to be in lock position when in uses

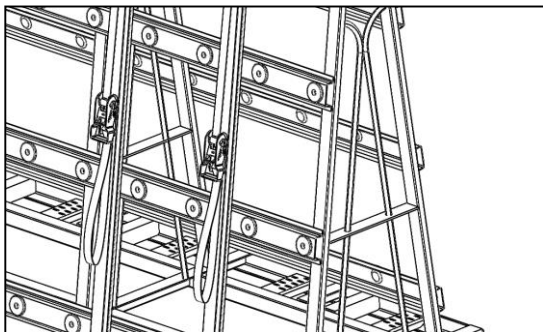

Examples



Double check
that ratchet are in
lock position
when driving

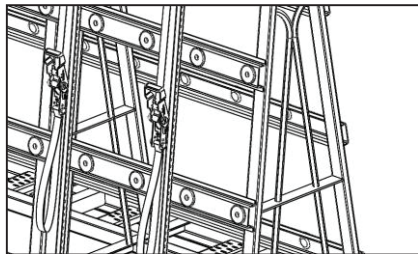
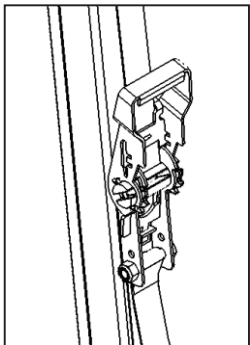

Note:

it's not a step ladder

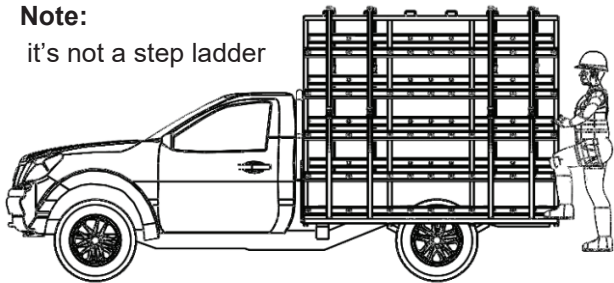

Examples of uses

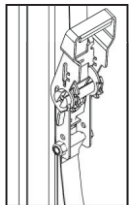

1. Ratchet are in free wheel position

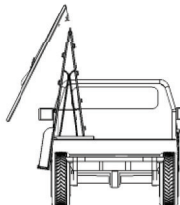

2. Fish for the strap hook

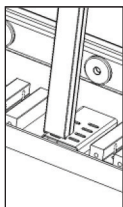
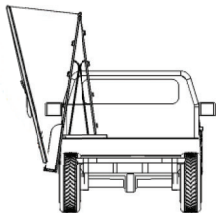

3. Pull back Ratchet pole and places bottom hook into the A-frame base slots

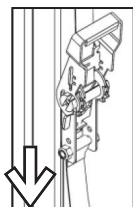
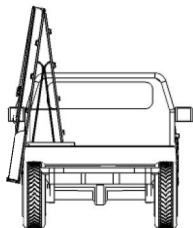

4. Pull The back strap down to educe slack

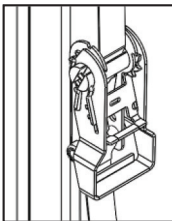
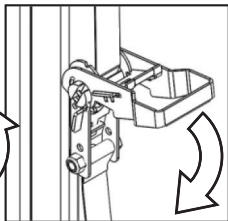
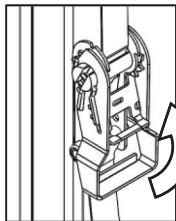

Lift handle upwards at 90 degrees and back down Repeat this until load is secure. When load secured set handle back to lock position.

WARRANTY:

This product is warranted for twelve months from date of purchase to be free of manufacturing defects in material and workmanship. This warranty does not cover transporting and handling on or off sites, nor does cover normal wear of parts or damage resulting from negligent use or misuse of the product, use or application contrary to installation instructions, or disassembly, repair or alteration by any person prior to authorization from a factory representative. Aacken or its agents are not liable for freight/handling or loss of production cost. Purchase must notify the agent prior to use if the new A-Frame has been damaged or components are missing.

DOCUMENT CONTAINER: (pre 2022)

Read Certificate, compliance labels, JSA, Manuals (prior to assembly ABA. RTAA).

2023 > - QR Barcode

Scan with mobile phone camera. Ensure internet connection is available (3G, Wifi etc). User will be able to download manuals and Certificates.

Or go to Aacken website (www.aacken.com) navigate to “my cert” > Enter batch number to locate the files.



Manual

**# Read and understand
manual and cert before use.**



Certificate

Rego-Vehicle Nr.....
Date fitted.....
Company name.....
address.....
Email.....T/Nr.....
Fitter signer

www.Aacken.com
Team@Aacken.com