

OWNER'S MANUAL

Buggy Lite

SS - 1100 - L2

This manual is provided in conjunction with instructions and spare part lists to fully inform the relevant personnel in usage and maintenance.

Contents

Warranty	1
Description	2
Features	2
Precautions	3
Safety Direction of Use	3
Assembly	4 - 6
JSA	7 - 8
Maintenance log	9
Part list drawing	10
Part list	11
Certificate	12

WARRANTY:

This product is warranted for twelve months from date of purchase to be free of manufacturing defects in material and workmanship. This warranty does not cover transporting and handling on or off sites, nor does cover normal wear of parts or damage resulting from negligent use or misuse of the product, use or application contrary to installation instructions, or disassembly, repair or alteration by any person prior to authorization from a factory representative.

Aacken or it agents are not liable for freight/handling or lost of production cost. Purchase must notify the agent prior to use if the new Buggy A-Frame has been damaged.

Description:

Buggy A-Frame SS - 1100 - L2

Built single sided slim line with load base rubberize support ledger. Excellent moveability in confine are. Fit through domestic door ways.

Two single sided A's support, two horizontal cross bar rubberizev ersatile to handle different sizes material

Features:

- Size **1100L x 560W x 1150H** (mm)
- Load bay rubberize stain proof beaded
- Double brake caster Ø 125 (5")
- Front - Rear guide tug handle
- Peg pole, load cam brace
- Tie rails base end's, & A's top hook's
- Pair ratchet straps
- Easy assembly
- Industrial powder coated

SS - 1100 - L2

- Tare weight 35 kgs
- Rubberize solid wheels Ø 280

Precaution:

- Ensure buggy in good condition
(not damage in transportation)
- All bolts are tight
 - Caster brake lock ok
- Buggy with load brace bar
- Read and understand compliance

Safety Use:

- Buggy to be on level surface for loading and unloading
- Caster brake to be locked for loading and unloading
- Load to be secure before moving buggy
- Do not leave load on buggy without safety peg brace bar adjusted against load
- Do not crane or fork buggy with load
- Do not exceed 525 kgs W.L.L.

**Aacken**
created with ingenuity built on integrity.

BUGGY LITE

SS - 1100 - L2

Year 202#

CE

Tare 35 kgs

W.L.L. 525 kgs

Stationary

W.L.L. 400 kgs

2 MEN WHEELING

W.L.L. 200 kgs

1 MAN WHEELING

B/Nr. BL12-2###

S/Nr. BL12-###

Assembly

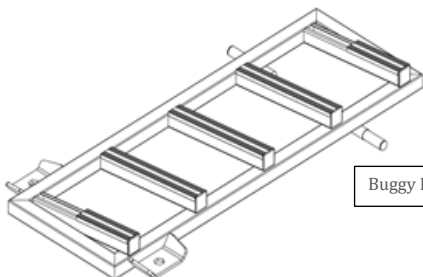

Buggy Base

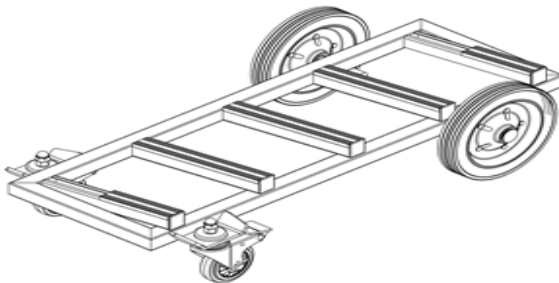
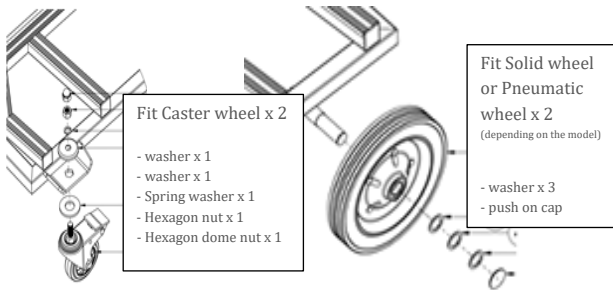

Assembly

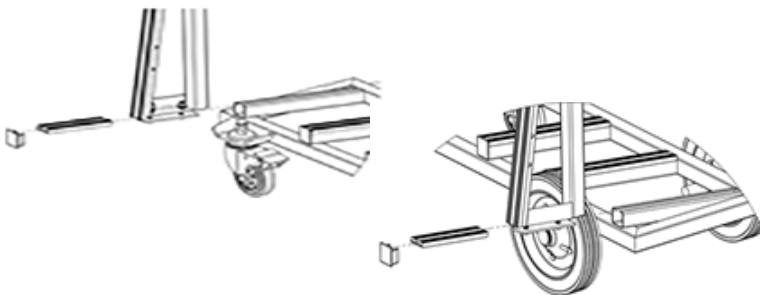
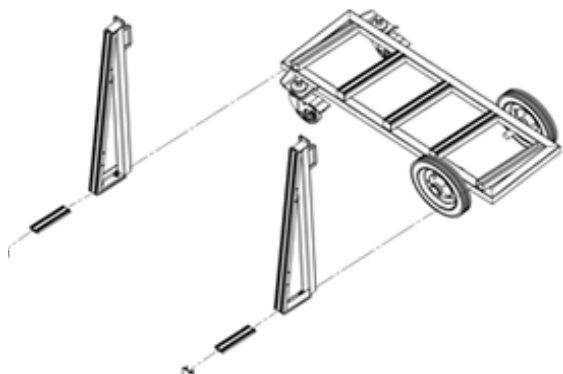

Slide in the A.

Rubber facing outwards.

Assembly

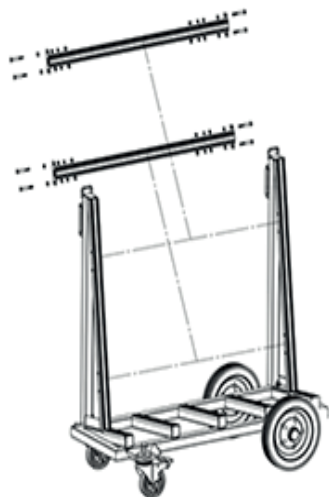

Add the two cross bars.

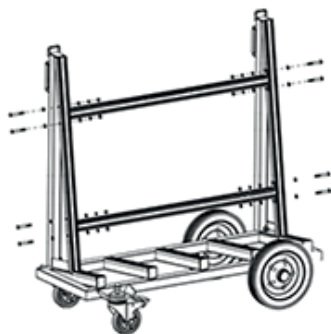

Job Safety Analysis (part 1)

Procedure(s) for Aframe Trolley

1. Read compliance plate on frame before using.
2. Function of the 'Trolley Rack Aframes' should only be managed by Personnel experienced in their use and that they (the operator) be advised of any potential hazard(s) associated with its use.
3. Recognized potential hazard(s):
A/.Crushing - (Risk Assessment Low)-Remote probability of crush injury to Bodily area of operator(s),of fatal consequences, subject to loss of load.
Crushing - (Risk Assessment Low)-Occasional probability of crush injury to feet area of operator(s),of negligible consequences, subject to entrapment of feet under casters wheels.
B/.Cuts, Stabs, Puncture - (Risk Assessment-Low)- Remote probability of cuts/stabs/punctures to bodily area of operator(s) of marginal consequence, subject to loss of load.
4. Function of the 'Trolley Rack Aframes', Buggy, Trolley type should only be done so wearing relevant Personal Protective Equipment - e.g. Steel toe Boots, Hand Protection Gloves, other if required Eye Goggles, Wrist Gauntlets, Hard Hat and Leather Apron,etc.
5. Function of the'Trolley Rack Aframes',Buggy Trolley type should only be done so with total and full concentration and free from distraction(s) from outside factors (e.g. no mobile phone).
6. Aframe- rack with heavy load wheeling to be tow-tug with elect-tug, or at ground ramps, or unlevelled, ground surfaces

Attention: Note!:

Prior to construction Job- Site (obtain in writing if eyelets are acceptable for craning) as some countries / State laws and Job-Site prohibit a frame with eyelets to be used.

- Keep maintenance records to ensure safety checks are carried out.
- Check and tighten the nut and bolts on frequent basis
- Always keep the product clean and away from grease or other foreign substances as they may cause the product to have an incorrect operation.
- Confirm all the welded joints are free from any defect, corrosion or damage, such as rust, separation, crack and so forth on a frequent basis.
- Store in a dry and cool place.

Job Safety Analysis (part 2)

SAFETY REQUIREMENTS WHEN LIFTING / MOVING LOAD

- It is strongly advised that correct 'Personal Protective Equipment' to be worn when operating.
- The operator is advised to warn other personnel in the near vicinity to keep clear when any load is being lifted or moved.
- Loading or unloading frame to be on level surface.
- Load not to be loaded or unloaded in windy or rainy conditions.
- Load to be secured before lifting frame with load or moving.
- Site craning load must be lower eyelets height and overhang length max 25%.
- Shrink-wrap or load netting must be used for site craning.
- Load material height not to exceed 30% of load bay height. (Storage)
- Load not to project 35% pass load bay length. (Storage, safety barrier must be used)
- Glass less than 6 mm must not exceed 300mm pass frame dimensions when 500 mm less in height.
- Load weight not to exceed W.L.L.
- Load cargo straps or load locking bars system must be used.
- Load cargo strap must be used outside load bay size dimensions.
- Top eyelets use only if load is secured, balance within eyelets W.L.L.
- Lifting frame, from fork pockets or eyelets should only be for short periods of time. <10 mins. Do not rush lifts. Have a plan with safety before execution.
- For excess or unbalance load use crane lifting slipper.
- Single sided models do not crane or forklift Buggy A-Frame with load.
- When moving a load, the operator(s) is advised to keep their feet and legs clear of the suspended material. The load must be steadied and controlled at arms length.
- Any load must be moved as near to floor level as is practical unless obstructions make it unsafe or impractical to do so.
- Forklift within A-Frame fork pocket, with Forktruck carriage against A-frame, except trucking roll on roll off GTR series
- Do not lift loaded space A-frame in a counter lever manner with Forktruck (accident or damage will occur!) use long tynes or slipper's
- Frames with load in factory or site not to move more than 2kph with retaining peg-cam brace lock in position, or slide retention post, if equip, otherwise ratchet - strapping to be used.

Maintenance log

Date	Status	Signature

SS - 1100 - L2

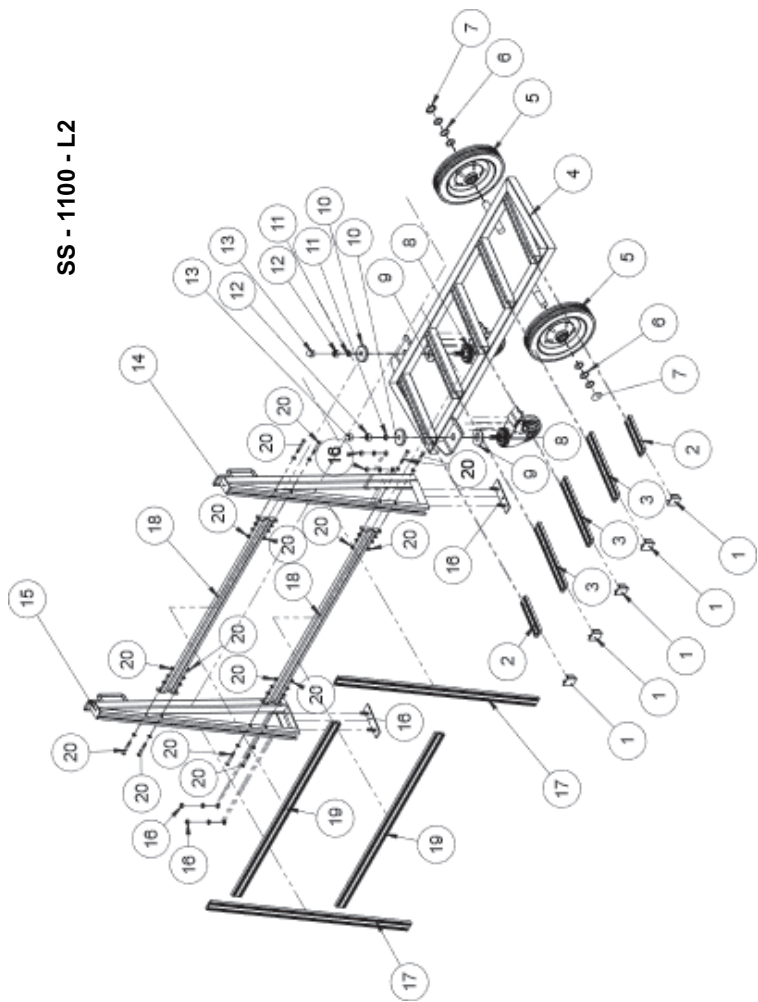

Parts List

1	Cap
2	Rubber
3	Rubber
4	Base Assem
5	Solid wheel 280
6	Washer
7	Push on cap or Circlip
8	Caster Wheel 125mm
9	Caster Wheel Large Washer
10	Caster Wheel Cap Washer
11	Spring Washer M16
12	M16 Nut
13	M16 Dome Nut
14	Left A-Assem
15	Right A-Assem
16	A-Assem base M10 set
17	Rubber A
18	Cross Bar Assem
19	Rubber Cross bar
20	Bolts Assem M8-60mm set